

# CARDIOVASCULAR RESEARCH MEETING

16 & 17 January 2024

UniS, University of Bern

## SPONSORSHIP BOOKLET



Cardio-vascular diseases are defined by the world health organization as “a group of disorders of the heart and blood vessels”, suggesting that strong interactions exist between the cardiac and vascular fields. That is why the working group of cardiovascular biology was founded by **clinicians and researchers** working in cardiology and in the vascular domain 20 years ago. This interaction is the specificity of our group, which is also supported by the Swiss Society of Cardiology (<http://www.swisscardio.ch>).

### **The focus of this meeting is:**

- To provide an open forum for **cardio-vascular** scientists (basic researchers and clinicians)
- To promote and enhance education for young colleagues
- To intensify collaborations among researcher within Switzerland and with industry
- To provide an annual meeting platform for network programs

The meeting will take place at the [UniS, University of Bern](https://www.unibe.ch).

**A dinner in the Bern old town will be the social highlight of this event.**

# Key facts

---

<b>Venue</b>	<a href="#">UniS, University of Bern</a>
<b>Audience</b>	Specialized audience from all Swiss Universities, ETHs working in the Cardiovascular field. <b>70-100 participants</b> (40% students, 40% postdocs, 20% PIs or clinicians)
<b>Why getting involved?</b>	The only Swiss meeting in basic research in Cardiology!
<b>Sponsoring opportunities</b>	Possibility for a booth and/or other sponsoring options, plus networking and informal one-to-one meetings with participants.
<b>Website</b>	<a href="https://meetings.ls2.ch/cardiovascular2024">https://meetings.ls2.ch/cardiovascular2024</a>
<b>Contact</b>	Dr. Adela Calvente Arroyo, scientific officer <a href="mailto:adela.calvente@ls2.ch">adela.calvente@ls2.ch</a>

# Sponsoring options

---

- 1. Gold Package** (limited to one company) **4000 CHF**
  - Booth at the meeting site (two tables 160x80 cm)
  - One merchandising item for registration desk\*\*: flyers, pens...*Floor plan below*
- 2. Silver Package** **2500 CHF**
  - Booth at the meeting site (one table 160x80 cm)
  - One merchandising item for registration desk\*\*: flyers, pens...*Floor plan below*
- 3. Lunch sponsoring** (limited to two companies) **2000 CHF**
  - The lunch will be called as company's name
  - Flyers\*\* will be distributed on the tables
  - One merchandising item for registration desk\*\*: flyers, pens...
- 4. Meeting bags and/ or Lanyards\*\*** **750 CHF/each**
  - Limited to a single company for each item

## 5. Merchandising & Advertisements

- Flyers\*\* or other merchandising items in meeting bag / registration desk **500 CHF**

## 6. Oral and Poster prizes\*

- Best oral or poster presentation **500 CHF/each**
- 2<sup>nd</sup> best oral or poster presentation **250 CHF/each**

**All prices are VAT excluded (+8.1% VAT)**

**In case the meeting would be cancelled due to the pandemic situation, every sponsoring option will be refunded.**

**All sponsoring options include the advertisement of the company's logo on website and welcome words. Sponsoring options of 2500 CHF or more include the invitation of two company representatives to the meeting. Costs for registration, lunch, coffee breaks will be covered. Dinner should be booked separately. We kindly ask the representatives to individually organize and pay for their hotel overnight stay, if needed.**

*\*Those are cash prize given directly to the winner of each category. The prize will be called as the company's name. The logo of the sponsor of oral and poster prizes will be showed in social media together with the announcement of the winners after the conference. The executive committee of the LS<sup>2</sup> Intersection Cardiovascular Biology reserves the right of splitting the prize between two winners if the scores are equal.*

*\*\* The material should be provided by the company and sent by post to the venue one week before the event*

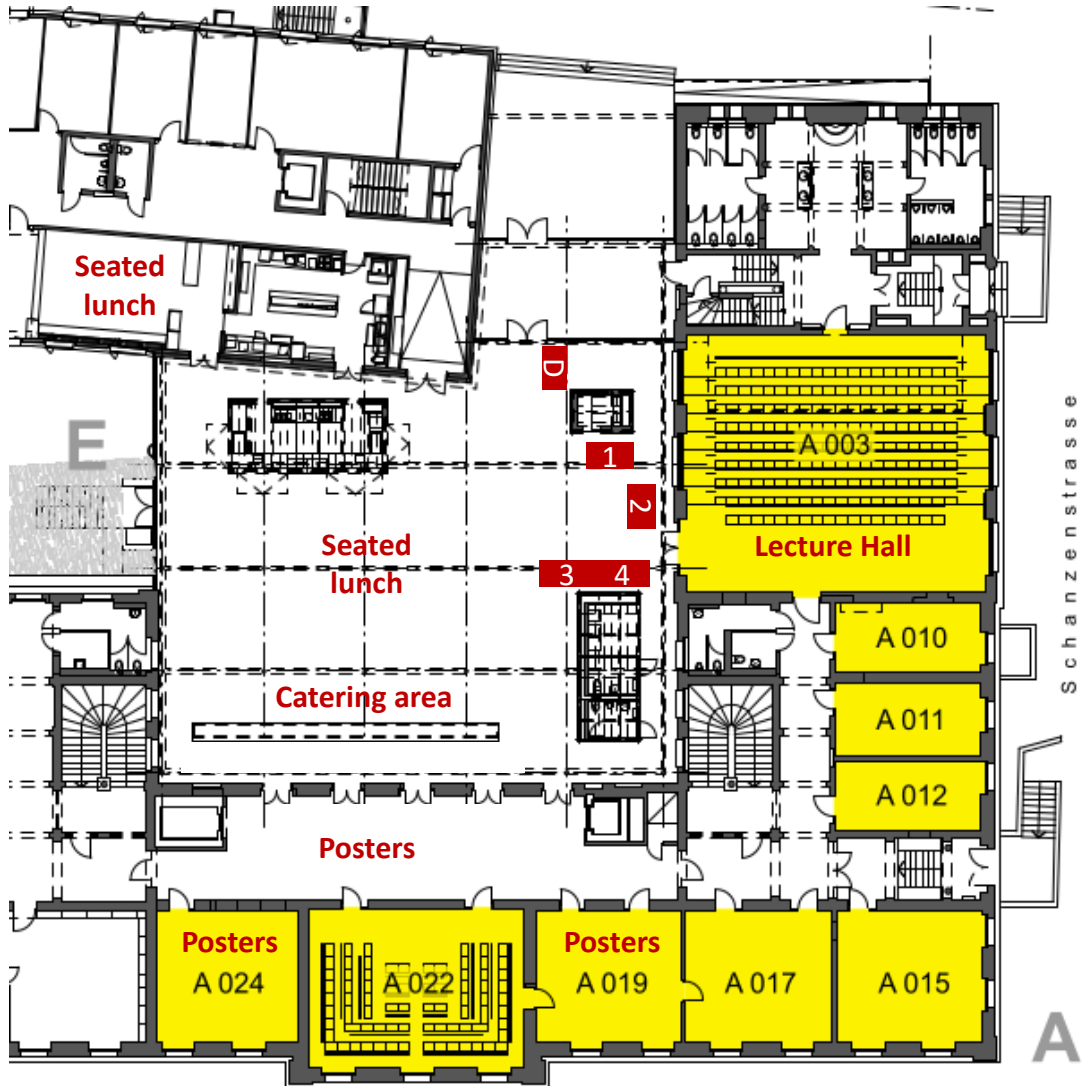

■ **Tables for booths: 160x80 cm. The location of the tables is orientative.**  
**Location for double booth: 3 + 4**

